

After format

inode alloc table

7 { 0 0 0 0 0 0 0 1  
0 0 0 0 0 0 0 0  
⋮

block alloc table

1 1 1 1 1 1 1 1  
0 0 0 0 0 0 1 1  
0 0 0 0 0 0 0 0  
⋮

inode 0

type: D  
nref: 1  
size: 2  
data:  
9  
unalloc  
unalloc  
unalloc  
⋮

directory block 9

" ." 0  
".." 0  
" " UNALLOC  
" " UNALLOC  
" " UNALLOC  
" " UNALLOC  
⋮  
⋮

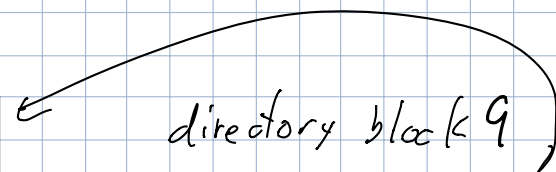

`fopen("foo", "w")`

inode alloc table

```
7 { 0 0 0 0 0 0 1 1  
   0 0 0 0 0 0 0 0  
   :  
   }
```

block alloc table

```
1 1 1 1 1 1 1 1  
0 0 0 0 0 0 1 1  
0 0 0 0 0 0 0 0  
:  
:
```

inode 0

```
type: D  
nref: 1  
size: 7 3  
data:  
  9  
  unalloc  
  unalloc  
  unalloc  
  :  
  :
```

directory block 9

```
"." 0  
".." 0  
"foo" 1  
"|" unalloc  
"|" unalloc  
"|" unalloc  
:  
:
```

```
type: F  
nref: 1  
size: 0  
data:  
  unalloc  
  unalloc  
  unalloc  
  unalloc  
  :  
  :
```

`fwrite(fp, "THX", 3)`

inode alloc table

7 { 0 0 0 0 0 0 1 1  
0 0 0 0 0 0 0 0  
:  
:

block alloc table

1 1 1 1 1 1 1 1  
0 0 0 0 0 1 1 1  
0 0 0 0 0 0 0 0  
:  
:

inode 0

type: D  
nref: 1  
size: 7 3  
data:  
9  
unalloc  
unalloc  
unalloc  
:  
:

directory block 9

" ." 0  
".." 0  
"foo" 1  
" " UNALLOC  
" " UNALLOC  
" " UNALLOC  
:  
:

type: F

nref: 1  
size: 0 3  
data:  
10  
unalloc  
unalloc  
unalloc  
:  
:

Data Block 10

T  
H  
X

`fwrite(fp, "1138", 4)`

inode alloc table

```
7 { 0 0 0 0 0 0 1 1  
   0 0 0 0 0 0 0 0  
   :  
   }
```

block alloc table

```
1 1 1 1 1 1 1 1  
0 0 0 0 0 1 1 1  
0 0 0 0 0 0 0 0  
:  
:
```

inode 0

```
type: D  
nref: 1  
size: 7 3  
data:  
  9  
  unalloc  
  unalloc  
  unalloc  
  :  
  }
```

directory block 9

```
" ." 0  
".." 0  
"foo" 1  
" " unalloc  
" " unalloc  
" " unalloc  
: :  
:
```

```
type: F  
nref: 1  
size: 9 7  
data:  
  10  
  unalloc  
  unalloc  
  unalloc  
  :  
  }
```

Data Block 10

```
J  
H  
X  
1  
1  
3  
8
```

*fwrite(fp, buf, 300)*

inode alloc table

```

7 { 0 0 0 0 0 0 1 1
    0 0 0 0 0 0 0 0
    :
  }
  
```

block alloc table

```

1 1 1 1 1 1 1 1
0 0 0 0 1 1 1 1
0 0 0 0 0 0 0 0
:
  
```

inode 0

```

type: D
nref: 1
size: 73
data:
  9
  unalloc
  unalloc
  unalloc
  :
  
```

directory block 9

```

" ." 0
".." 0
"foo" 1
" " UNALLOC
" " UNALLOC
" " UNALLOC
:
:
  
```

type: F

```

nref: 1
size: 307
data:
  10
  11
  unalloc
  unalloc
  :
  
```

Data Block 10

```

T
H
X
:
3
8
:
  
```

Data Block 11

```

:
:
:
:
:
:
  
```

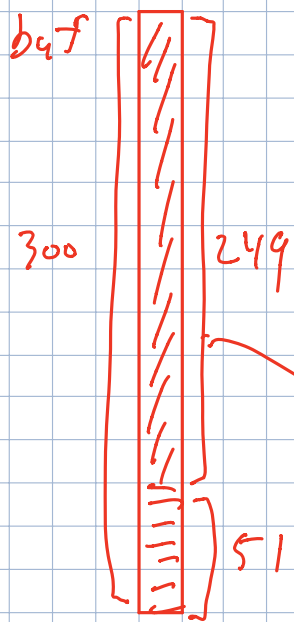

Copy

Copy

